

NOTES:

- DO NOT SCALE. USE FIGURED DIMENSIONS ONLY.
- THIS DRAWING IS TO BE READ IN CONJUNCTION WITH ALL OTHER RELEVANT ARCHITECTURAL AND ENGINEERING DRAWINGS.

LEGEND:

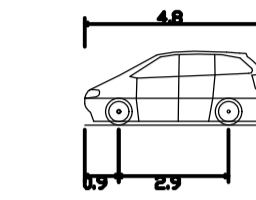
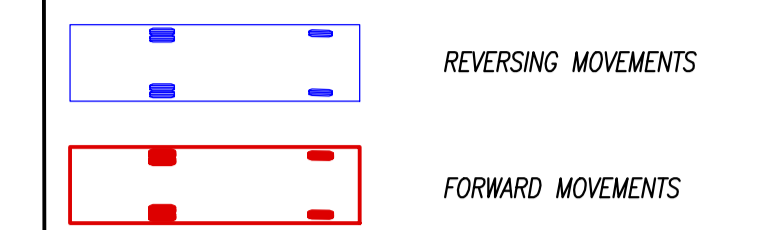

Standard Design Vehicle (SDV)  
 Overall Length 4.800m  
 Overall Width 2.000m  
 Overall Body Height 1.950m  
 Min Body Ground Clearance 0.100m  
 Track Width 2.000m  
 Lock-to-lock time 4.00s  
 Wall to Wall Turning Radius 6.000m

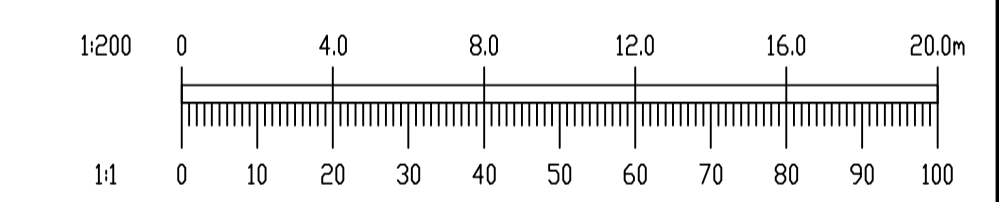
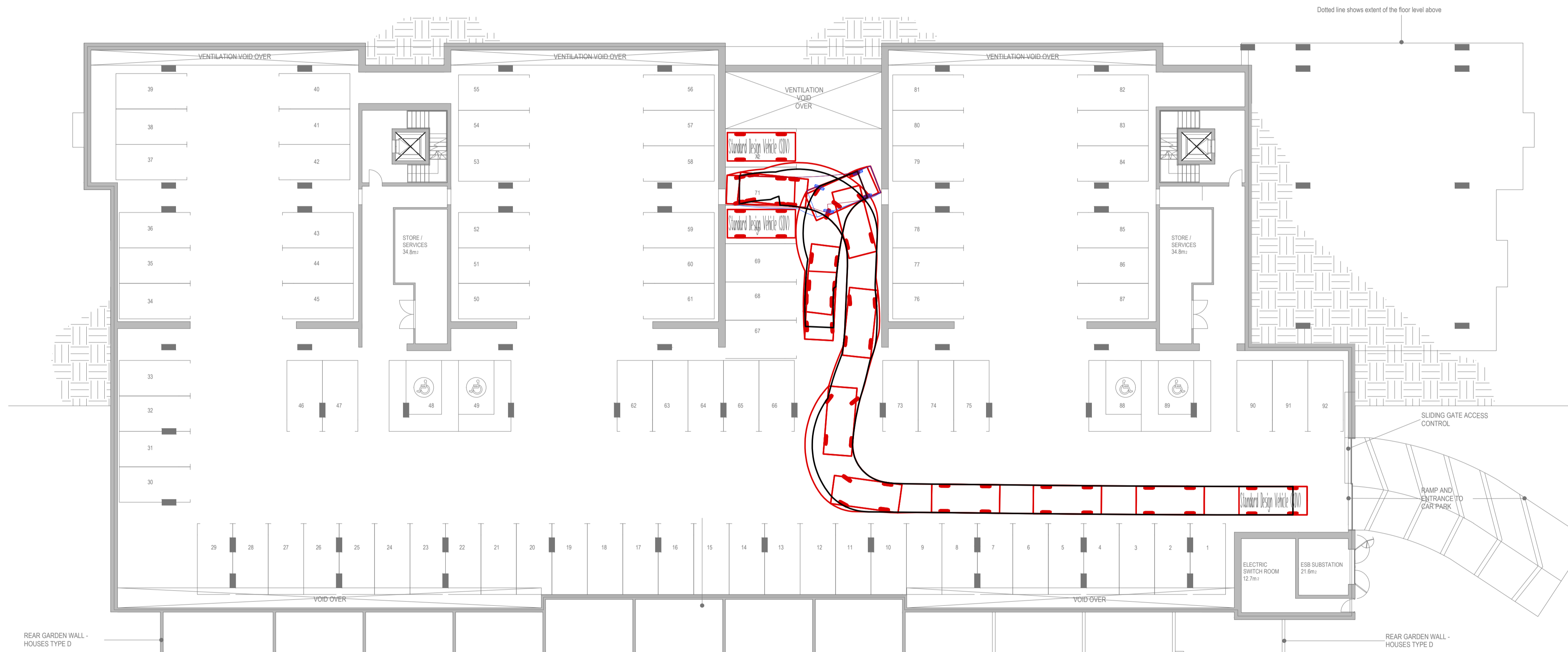
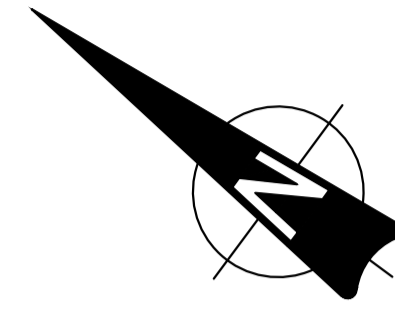

REV.	DATE	AMENDMENT	DRN	APPD

STATUS **FOR PLANNING  
NOT FOR CONSTRUCTION**

**Waterman Moylan**  
 Engineering Consultants  
 BLOCK 5, EASTPOINT BUSINESS PARK, ALFIE BYRNE ROAD,  
 DUBLIN D03 H3F4 IRELAND. Tel: (01) 664 8900  
 Email: info@waterman-moylan.ie www.waterman-moylan.ie

CLIENT **BALLYMORE PROPERTY DEVELOPMENTS LTD**  
 ARCHITECT **REDDY ARCHITECTURE**

PROJECT  
**RESIDENTIAL DEVELOPMENT,  
 SEAMOUNT, MALAHIDE, CO DUBLIN**

TITLE  
**SWEPT PATH ANALYSIS  
 SHEET 2 OF 2  
 (APARTMENT BLOCK BASEMENT)**

DRAWN <b>PW</b>	DESIGNED <b>AK</b>	APPROVED <b>IW</b>	DATE <b>NOV. '19</b>
SCALE <b>1:750@A1</b>	JOB NO. <b>18-001</b>	DRG. NO. <b>P315</b>	REVISION